

ELEVATION A



Artist's conceptual interpretation. Subject to change.

ELEVATION B



Artist's conceptual interpretation. Subject to change.

STYLE & ELEGANCE are the hallmarks of the Bridgeport. A welcoming front porch and coastal architecture greet you as you enter. Inside, the large great room, dining, and kitchen offer the ideal space for entertaining or family evenings together. The luxurious owners' suite is a lovely retreat after a day boating on the Sound. A back deck and screened porch make outdoor living a breeze. Enjoy the space and flexibility of a bonus room and attached 2-car garage, too.

3 BEDROOMS | 3 BATHROOMS | 2,564 SF

PRESERVE HOMES & NEIGHBORHOODS
NEW HOMES: HOUSE & LOT

ELEVATION A: FROM \$584,900.*

ELEVATION B: FROM \$589,900.*

*SUBJECT TO LOT EVALUATION.

For more information about The Bridgeport, or a personal property tour, contact us!
(800) 523-5958 info@AlbemarlePlantation.com ALBEMARLEPLANTATION.COM

PRICES AND SPECIFICATIONS
AS OF 9-1-22.



The BRIDGEPORT

AT ALBEMARLE PLANTATION



FIRST FLOOR

ELEVATION A

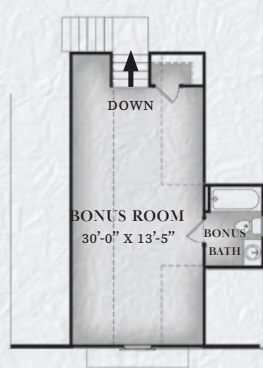

SECOND FLOOR



FIRST FLOOR

ELEVATION B

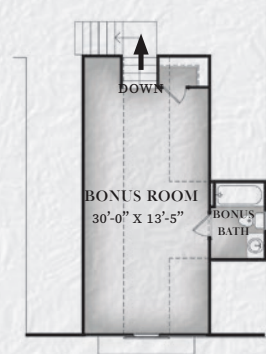

SECOND FLOOR

Artist's conceptual interpretation. Subject to change.

PRICES AND SPECIFICATIONS AS OF 9-1-22.

For more information about The Bridgeport home plan or a personal property tour, contact us! (800) 523-5958

info@AlbemarlePlantation.com ALBEMARLEPLANTATION.COM



*All renderings are artist's concept contained herein are for illustration purposes only. Renderings and floor plans subject to modification. Pricing, details, features and square footage subject to change without notice. The information contained herein is for informational purposes only and may change at any time without notice. Void where prohibited. AP Realty Company, LLC/Broker